

DATASHEET

COMPARTMENT FLOOR WITH CEMENT SCREED

GD15.02

VISIBLE CEILING

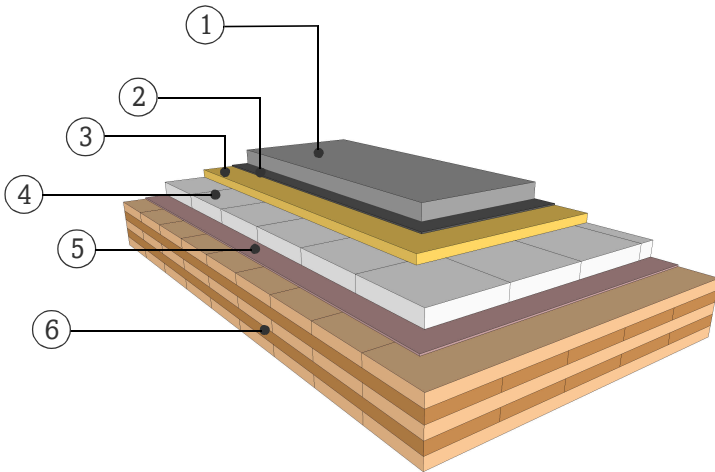

FIRE RESISTANCE

Pre-dimensioning one-sided fire attack

R*EI 30 > 3s 80 TL

R*EI 60 > 5s 120 TL

R*EI 90 > 5s 150 TL

*For residual load capacity or alternative design see <https://www.klhdesigner.at/>

SOUND INSULATION

R_w (C;C_{tr}) 60 (-1;-3) [dB]

L_{n,w} (C_l) 43 (1) [dB]

<https://www.klh.at/en/online-component-catalogue/>

THERMAL PROTECTION

U 0,40 [W/m²K]

m_{w,B,A} 36/106 [kg/m²]

	MATERIAL	PROPERTIES				
		λ [W/mK]	μ min-max [-]	ρ [kg/m³]	c [kJ/kgK]	
①	60.0 Cement screed	1.4	50	2200	1.1	A1
②	Separating layer					
③	30.0 Impact sound insulation, s'≤ 7 MN/m³	0.032	1	110	0.84	A1
④	50.0 Concrete elements	1.7	100	2400	1.08	A1
⑤	5.0 Acoustic sheet s'≤ 115 MN/m³	0.045	20000	1400	1	E
⑥	150.0 TL, KLH solid timber slab	0.12	50 - 300	470	1.6	D

Thickness 295,0 [mm]

Mass per squaremeter ca. 325 [kg/m²]

Test report sound: HFA 169/2015-BB
Calculation of the physical values by the
KLH Massivholz GmbH, without warranty