

DATASHEET

STEEP ROOF WITH TILES

STD12.02

VISIBLE CEILING

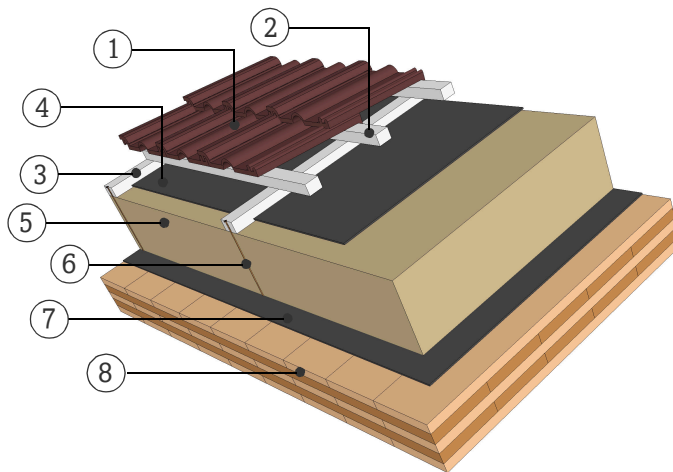

FIRE RESISTANCE

Pre-dimensioning one-sided fire attack

R*EI 30 > 3s 80 TL**R*EI 60** > 5s 120 TL**R*EI 90** > 5s 150 TL

*For residual load capacity or alternative design see
<https://www.klhdesigner.at/>

SOUND INSULATION

 $R_w (C; C_{tr})$ 50 (-4;-11) [dB]
<https://www.klh.at/en/online-component-catalogue/>

THERMAL PROTECTION

 U 0,13 [W/m²K] $m_{w,B,A}$ 35 [kg/m²]

MATERIAL

PROPERTIES

	[mm]	λ [W/mK]	μ min-max [-]	ρ [kg/m³]	c [kJ/kgK]	
①	Roof tiles					A1
②	30.0 Timber batten (spruce) horizontal, 3x5 cm					D
③	40.0 Timber batten (spruce) vertical, 3x5 cm					D
④	Underroof sheet, breather membrane					
⑤	240.0 Wood fiberboard	0.042	5	< 180	2.1	E
⑥	Screws					A1
⑦	Vapour barrier $s_d \leq 100m$					
⑧	160.0 TL, KLH solid timber slab	0.12	50 - 300	470	1.6	D

Thickness 470,0 [mm]

Mass per squaremeter ca. 155 [kg/m²]

Test report sound: HFA 1253/2012 - BB
 Calculation of the physical values by the
 KLH Massivholz GmbH, without warranty