

DATASHEET

STEEP ROOF WITH METAL SHEET

STD12.07

SELF SUPPORTING FORMWORK

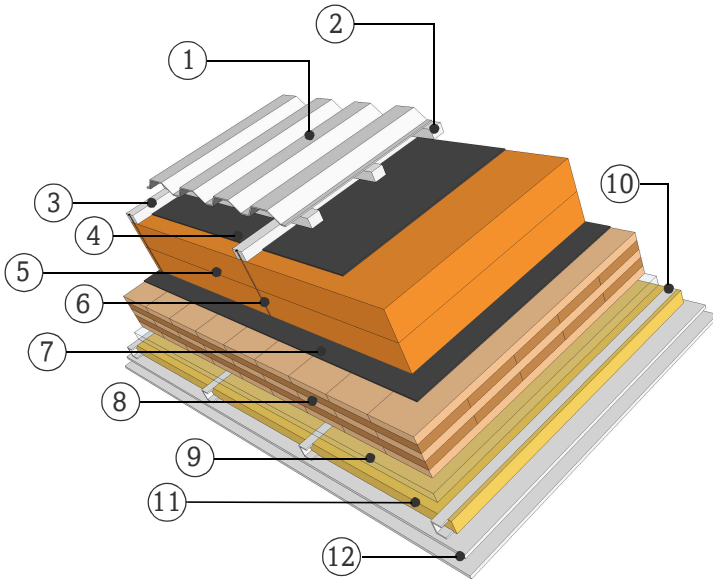

FIRE RESISTANCE

Pre-dimensioning one-sided fire attack

**R\*EI 30** > 3s 80 TL

**R\*EI 60** > 5s 120 TL

**R\*EI 90** > 5s 150 TL

\*For residual load capacity or alternative design see <https://www.klhdesigner.at/>

SOUND INSULATION

**R<sub>w</sub> (C;C<sub>tr</sub>)** 59 (-3;-10) [dB]

<https://www.klh.at/en/online-component-catalogue/>

THERMAL PROTECTION

**U** 0,09 [W/m²K]

**m<sub>w,B,A</sub>** 18 [kg/m²]

MATERIAL

PROPERTIES

[mm]		$\lambda$ [W/mK]	$\mu$ min-max [-]	$\rho$ [kg/m³]	$c$ [kJ/kgK]	
①	Trapezoidal sheet					A1
②	30.0 Timber batten (spruce) horizontal, 3x5 cm					D
③	40.0 Timber batten (spruce) vertical, 3x5 cm					D
④	Underroof sheet, breather membrane					
⑤	240.0 Polyurethane Insulation	0.025	60	30	1.4	E
⑥	Screws					A1
⑦	Vapour barrier sd ≤ 100m					
⑧	160.0 TL, KLH solid timber slab	0.12	50 - 300	470	1.6	D
⑨	85.0 Air gap					
⑩	50.0 Lightweight C-profiles					A1
⑪	50.0 Mineral wool, low density	0.038	1	40	0.9	A1
⑫	25.0 Gypsum plasterboard	0.25	10	680	0.96	A2

Thickness 630,0 [mm]

Mass per squaremeter ca. 120 [kg/m²]

Test report sound: HFA 1253/2012 - BB  
Calculation of the physical values by the  
KLH Massivholz GmbH, without warranty